

Dynamic Analysis of Machine Foundation

Manohar.D¹, B.K. Raghu Prasad², Dr.K. Amarnath³

¹Student, The oxford College of Engineering, Bangalore, Karnataka, India

²Former Professor, The Oxford College of Engineering, Bangalore, Karnataka, India

³HOD, Civil Department, The Oxford College of Engineering, Bangalore, Karnataka, India

Abstract – The analysis of Machine Foundation involves not only static loads but also the dynamic loads which are caused due to the working of the machine. Therefore, the machine foundation should survive these loads. Therefore, it becomes vital to reduce the natural frequency of soil beneath the foundation. One such treatment is to prepare a layered soil beneath the foundation by trenching the soil and placing different types of isolation materials.

Key Words: Frame foundation, Sinusoidal load, Rubber, Rock basalt, Springs, etc

1. INTRODUCTION

The dynamic loads that act on the machine foundations may be caused due to various reasons such as vibrations of machines while in running conditions, due to the vehicles moving on top of the foundations, in case of impact machines due to the impact of hammers, nuclear blasts in the vicinity, shock waves etc.

Therefore, as a designer one should be thorough with the ways with which these dynamic loads can be transmitted from machines to the soil beneath the foundation which can either be done by providing an elastic support such as rubber or a spring underneath the foundation in order to reduce the vibrations.

2.0 RECENT STUDIES AND OBJECTIVE

Shamsher Prakash (2006) discusses the method for determining the responses of foundations subjected to vibrating loads. Here the soil-foundation system is assumed as spring mass – dashpot model. Here the block foundation is considered. Mulugeta (2003) aims at incorporating impedance function by using expressions and dimensionless graphs for determining the dynamic stiffness and dashpot coefficients. In the paper by Piyush K (2014) reciprocating machines are installed on a block foundation on the ground surface as well as placed at different depths. Here the values of frequency and amplitude in different modes of vibration are compared.

Karlik (2013) has presented on the sensitivity and reliability analysis of machine foundation depending on the soil stiffness. Silipus (2015) has discussed the analytical and numerical models as how complex have to be in order to model the vertical dynamic response of machine foundation system. S. Patel has studied the foundation supporting rotary

type of machines. There two types of rotary machines under consideration in his paper Attar (2016) has presented methods to reduce vibrations by different isolation materials which are placed between the block foundation and the machinery. Nikhil (2016) presents the test sample for a roto dynamic model at various speed. It also discusses the various types of foundation which produces min vibration for a particular type of machine.

2.1 Objective

In design of machine foundation, it is vital to reduce the natural frequency of the soil beneath the foundation, which by doing so the vibrations produced can be easily dealt with.

One such treatment is to prepare a layered soil beneath by trenching the soil and prepare a layered soil by proper combination of different types. In this thesis, an attempt is made to reduce the vibrations transferred from machines to the foundations (frame type) by using layered soil medium underneath the foundation.

3.VIBRATION ISOLATION FOR MACHINE FOUNDATION

Even if the machines are rigidly connected to the floor ,the vibrations created by these machines get transmitted through the floor and to the soil below the foundation which will be large,even at long distances the transmitted vibrations create harmful effects. Also when these machine foundations are provided with elastic material there is a danger of creating resonance condition due to elasticity of the material

3.1 Following steps will help to reduce the vibrations upto a certain extent

- (i) **Selection of sites for the foundations** : The machinery and the foundation should be located as far as possible from the foundations of adjacent structures in order to reduce the vibrations felt by the adjacent structures.
- (ii) **Dynamic loads should be well balanced:** The machine should be so balanced that even after the dynamic loads are applied it should be nullified without causing any harmful effects.

(iii) **Providing Suitable foundations** :Depending on the type of machine ,the load coming on the foundation ,its operating freequency ,the designer should design the foundation in such a manner so as to reduce the vibrations being transmitted from machine to the soil below the foundation

(iv) **Providing proper isolation:** When machine foundations are unavoidably very close to the adjoining structures, the care should be taken to properly isolate the other structures from machine foundation by proving isolation material such as rubber or wood below the machine foundation.

4. ANALYTICAL STUDY

Frame Foundation

Frame type machine foundations usually consists of structural members such as beams, columns and slabs. The slabs are placed at the top in order to support the machinery. These structural members are constructed either in RCC or composite materials.

Section properties

Column section- 200mmX450mm

Beam section -200mmx300mm

Slab 200mm

Loading

Dead load of machine -2000 kg

Operating frequency - 1500 rpm – 25 cycles/sec

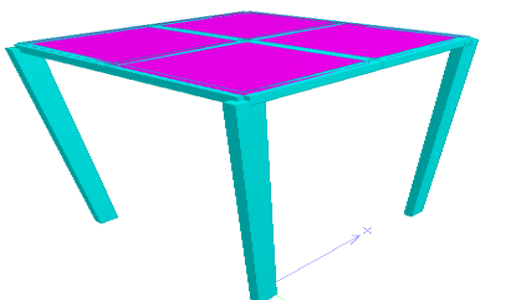
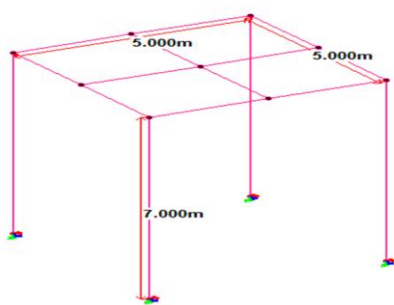

Fig -1: STAAD model

4.1 Determining the natural frequency of the system and plotting frequency response curves

Considering that the columns are infinitely rigid, the slab stiffness can be determined using the slab deflection formula:

$$Y_{max} = 0.0454x(q_0 \times a^4) / (Eh^3)$$

Here q = Load

a = slab dimensions = 5m

E = Young's modulus of concrete = 40Gpa

h = thickness of the slab = 0.2m

considering Ymax as unity we get load as 11.27 kN/ m, this is also the stiffness of the slab. On comparing the slab stiffness with the stiffness of the spring we can neglect the slab stiffness since it is very small.

$$1/K_{eff} = (1/11.27) + (1/15000)$$

Therefore $K_{eff} = 11.26 \text{ kN/ m}$

$$\text{Frequency} = 1/2\pi (\text{sqrt} (k/m))$$

$$= 0.37 \text{ Hz}$$

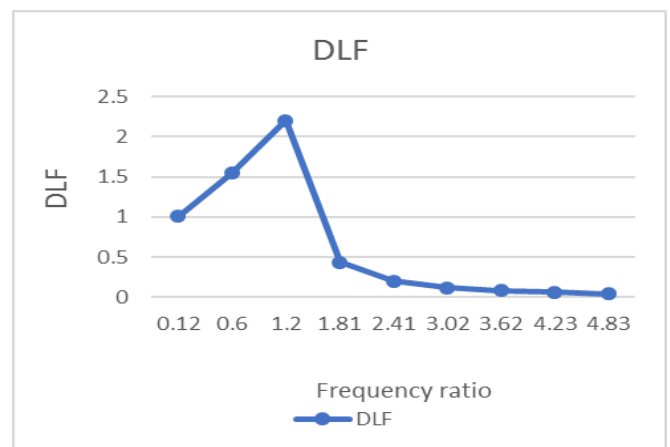

Chart -1: For K = 15000 kN/ m

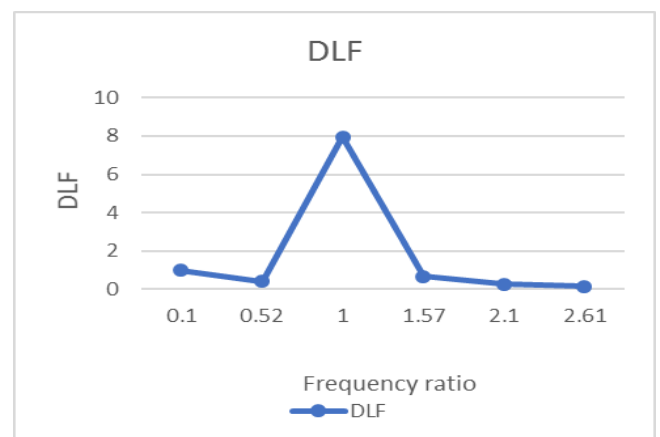

Chart -2: For K = 20000 kN/ m

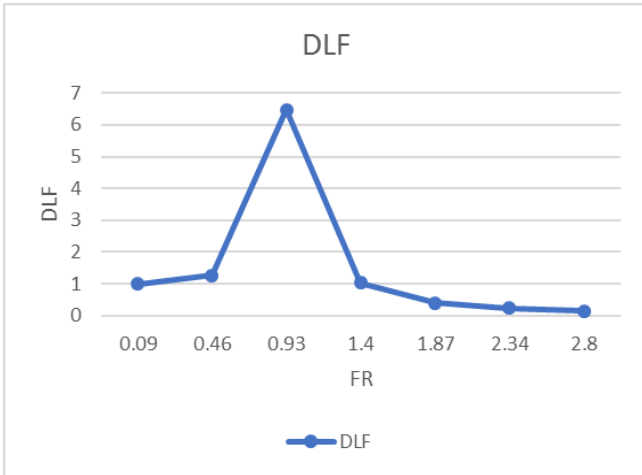

Chart -3: For K = 25000 kN/ m

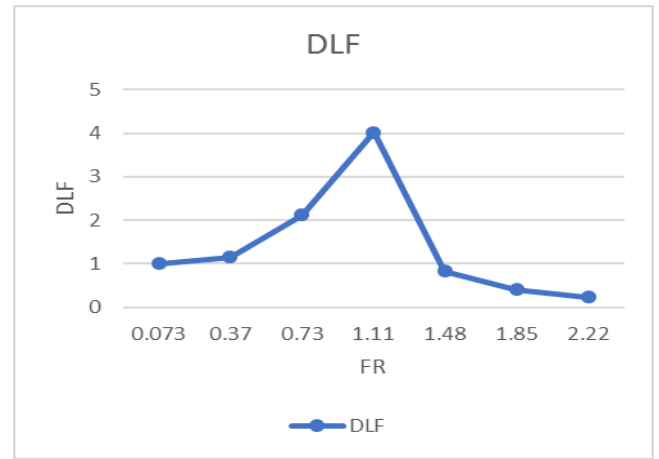

Chart -6: For K = 40000 kN/ m

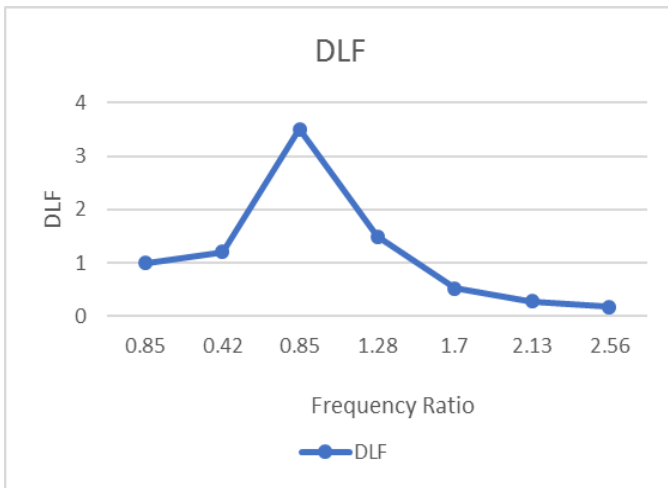

Chart -4: For K = 30000 kN/ m

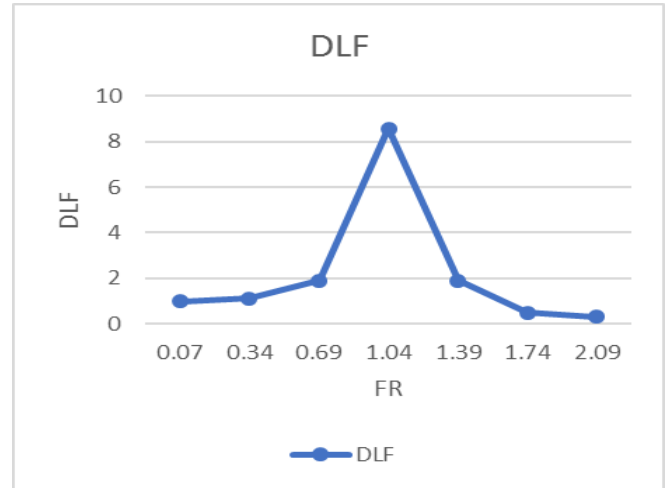

Chart -7: For K = 45000 kN/ m

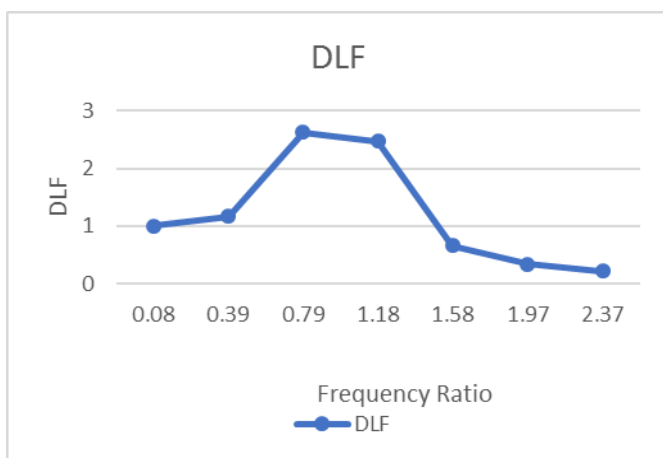

Chart -5: For K = 35000 kN/ m

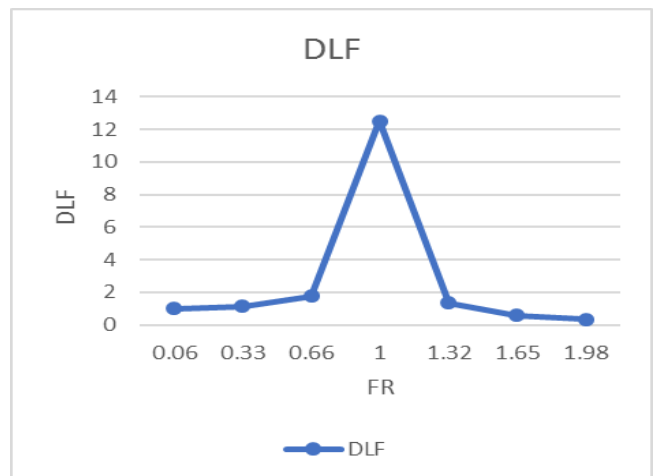

Chart -8: For K = 50000 kN/ m

